

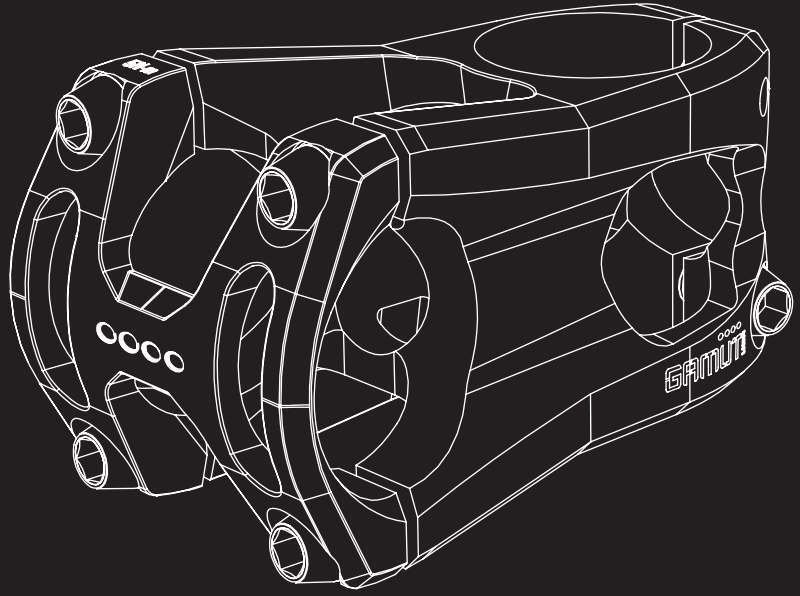

CILLOS STEM & HANDLEBAR INSTRUCTIONS



2013 CILLOS STEM & HANDLEBAR INSTALLATION INSTRUCTIONS

Gamut USA
3540 Charter Park Dr
San Jose, CA 95136
support@gamutusa.com
www.gamutusa.com

TOOLS REQUIRED:

- 4mm & 5mm allen (hex) keys
- Torque wrench

TORQUE REQUIREMENT	
N-m	in-lbs
5-8	44-71

Tighten all bolts using a torque wrench set to 5-8 Nm (44-71 in-lbs).

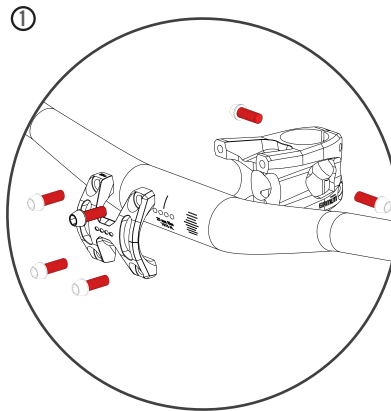

Grease the threads of all bolts before installing stem.

Slide stem onto steer tube, and add/remove spacers to ensure you achieve the 2-3mm gap between the top surface of the stem (or spacer) and top surface of the steer tube.

Install headset top cap and top cap bolt. Tighten headset top cap bolt to manufacturer's recommended specifications.

Turn stem side-to-side to center with front wheel. Once stem is centered, tighten the side steer tube clamp bolts to the proper torque settings.

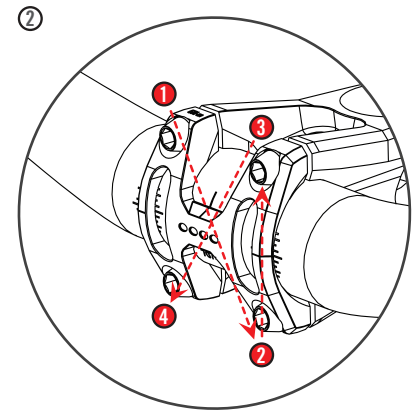

Install your handlebar in the stem. Replace stem faceplate, and then re-install all 4 stem faceplate bolts. Before tightening stem faceplate bolts, ensure the handlebar is centered in the middle of the stem and the rotation of the handlebar is positioned to your preference.

Once the handlebar is properly positioned in the stem, alternate tightening the 4 bolts in a cross-pattern until the proper torque setting is achieved (refer to illustration above). Ensure the gap between the stem faceplate and the stem body is equal on top and bottom of stem.

